

Pioneer Bay Estate – Workshop Sheet

Proposed Road and Drainage Improvement Project

If you were unable to attend the Community Workshop on 27 April 2016, we would appreciate it if you could complete the questions below and return this form by email or post.

| | |
|-------------------|--|
| Name: | |
| Property Address: | |
| Postal Address: | |
| Contact Number: | |
| Email Address: | |

Key Themes:

CARPARKING – Answer the following questions

| | |
|--|--|
| How many cars do you have? | |
| Do you have any larger vehicles? eg: truck/trade ute/van | |
| Do you have a boat or trailer? | |
| Do you have visitors? Where do they park? | |

LANDSCAPING – Review each of the four sketches and answer Yes or No (yes being your preferred style of landscaping and no being you do not like the look of the landscaping) based on a series of questions relating to each sketch.

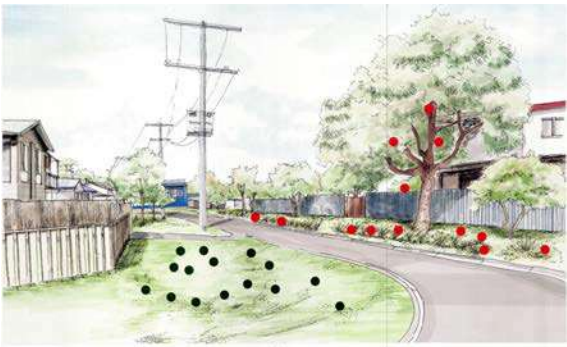
| SKETCH I | | | |
|---|---|---|---|
|  | <p>Do you prefer grass only?</p> <p>Yes</p> <p>No</p> | <p>Do you prefer smaller trees and shrubs?</p> <p>Yes</p> <p>No</p> | <p>Do you prefer larger trees?</p> <p>Yes</p> <p>No</p> |

SKETCH 2

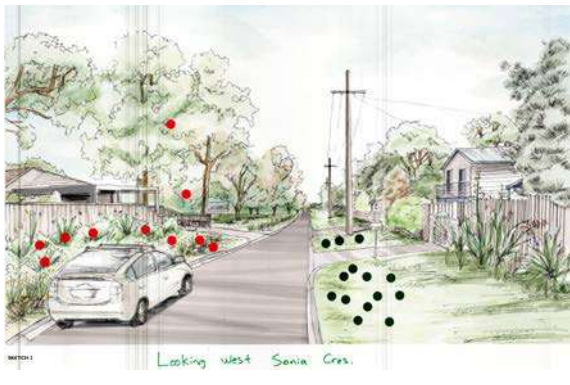

| | | |
|---------------------------|------------------------------------|-----------------------------|
| Do you prefer grass only? | Do you prefer swale (open) drains? | Do you prefer larger trees? |
| Yes | Yes | Yes |
| No | No | No |

SKETCH 3

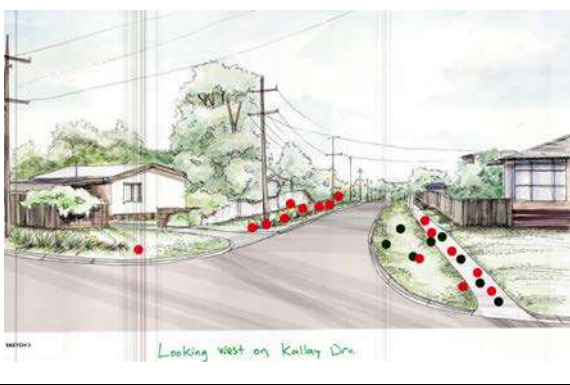

| | | |
|------------------------------------|---|---------------------------|
| Do you prefer swale (open) drains? | Do you prefer smaller trees and shrubs? | Do you prefer a footpath? |
| Yes | Yes | Yes |
| No | No | No |

SKETCH 4





| | | |
|---------------------------|---|-----------------------------|
| Do you prefer grass only? | Do you prefer smaller trees and shrubs? | Do you prefer larger trees? |
| Yes | Yes | Yes |
| No | No | No |

PEDESTRIAN MOVEMENTS – Mark on the plan (shown on the next page) your walking path throughout the Estate. If you cannot print out the plan, please describe your walking path in the comments below.

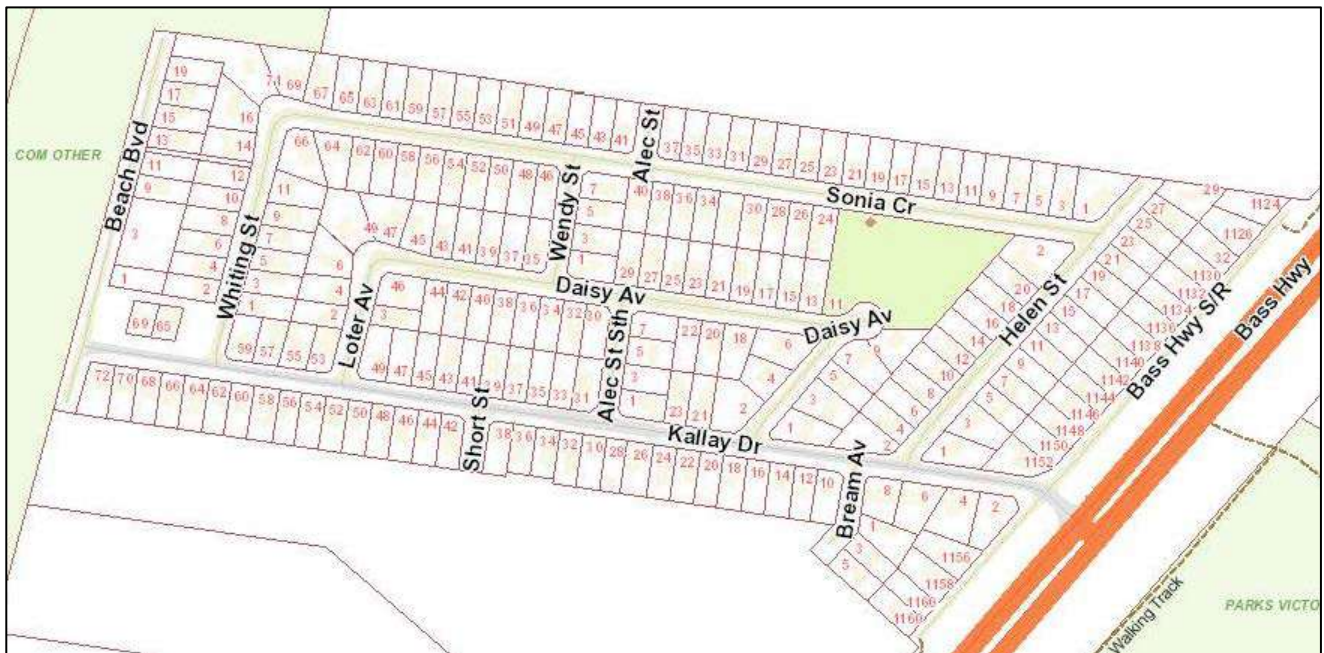
Movements/Comments:



TRAFFIC MOVEMENTS AND DEVICES – Review each style of traffic calming device and select which would be your most preferred option.

| | |
|---|--|
| Cul-de-sac with hump | |
|  | <p>Pros:</p> <ul style="list-style-type: none"> • Reduces Speed over a longer distance • Discourages through traffic • Provides landscaping opportunity • Better for emergency service use <p>Cons</p> <ul style="list-style-type: none"> • Reduces on street parking • Possibility of increased noise • Opposing drivers at the same time could cause problems • May push traffic to surrounding streets • Moderate cost to install and maintain |
| Single Lane Slow Point | |
|  | <p>Pros:</p> <ul style="list-style-type: none"> • Reduces Speed over a longer distance • Reduces overall speed • Provides landscaping opportunity <p>Cons</p> <ul style="list-style-type: none"> • Reduces on street parking • Landscaping requires maintenance • Possibility of increased noise • Opposing drivers at the same time may cause problems • May push traffic to surrounding streets |

Single Lane Flat Top Speed Hump



Pros:

- Reduces Speed over a longer distance
- Discourages through traffic
- Reduces overall speed
- Provides landscaping opportunity

Cons

- Reduces on street parking
- Possibility of increased noise
- Opposing drivers at the same time may cause problems
- May push traffic to surrounding streets
- Expensive treatment

Two Way Flat Top Speed Hump



Pros:

- Reduces Speed in vicinity of hump
- Reduces overall speed
- Discourages through traffic
- Smoother ride over device
- Relatively low cost to install and maintain

Cons

- Possibility of increased noise
- May push traffic to surrounding streets

Watt Profile Two Way Speed Hump



Pros:

- Reduces Speed in vicinity of hump
- Reduces overall speed
- Discourages through traffic
- Relatively low cost to install and maintain

Cons

- Possibility of increased noise
- May push traffic to surrounding streets

| | |
|---|--|
| <p>My MOST preferred Option is:</p> <ul style="list-style-type: none"> Cul-de-sac with Hump Single Lane Slow Point Single Land Flat Top with Hump Two Way Flat Top Speed Hump Watt Profile Two Way Speed Hump | <p>My LEAST preferred Option is:</p> <ul style="list-style-type: none"> Cul-de-sac with Hump Single Lane Slow Point Single Land Flat Top with Hump Two Way Flat Top Speed Hump Watt Profile Two Way Speed Hump |
| <p>Comments:</p> | |

Mark on the plan below your traffic movements throughout the Estate. If you cannot print out the plan, please describe your driving path in the comments below.

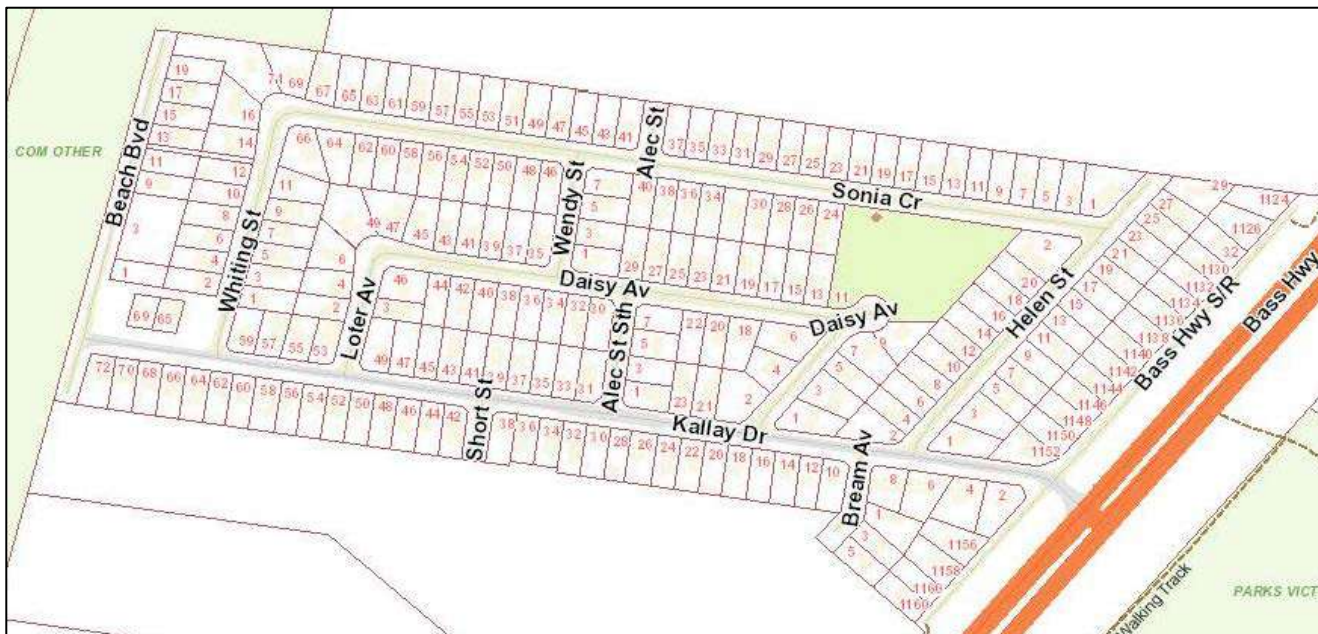

Movements/Comments:

Please return your completed form to Bass Coast Shire Council by:

- **Mail** Bass Coast Shire Council, PO Box 118, Wonthaggi VIC 3995
- **Email** infrastructureprojects@basscoast.vic.gov.au; or
- **In Person** at any of our Customer Service Centres