

DEVELOPMENT PLAN

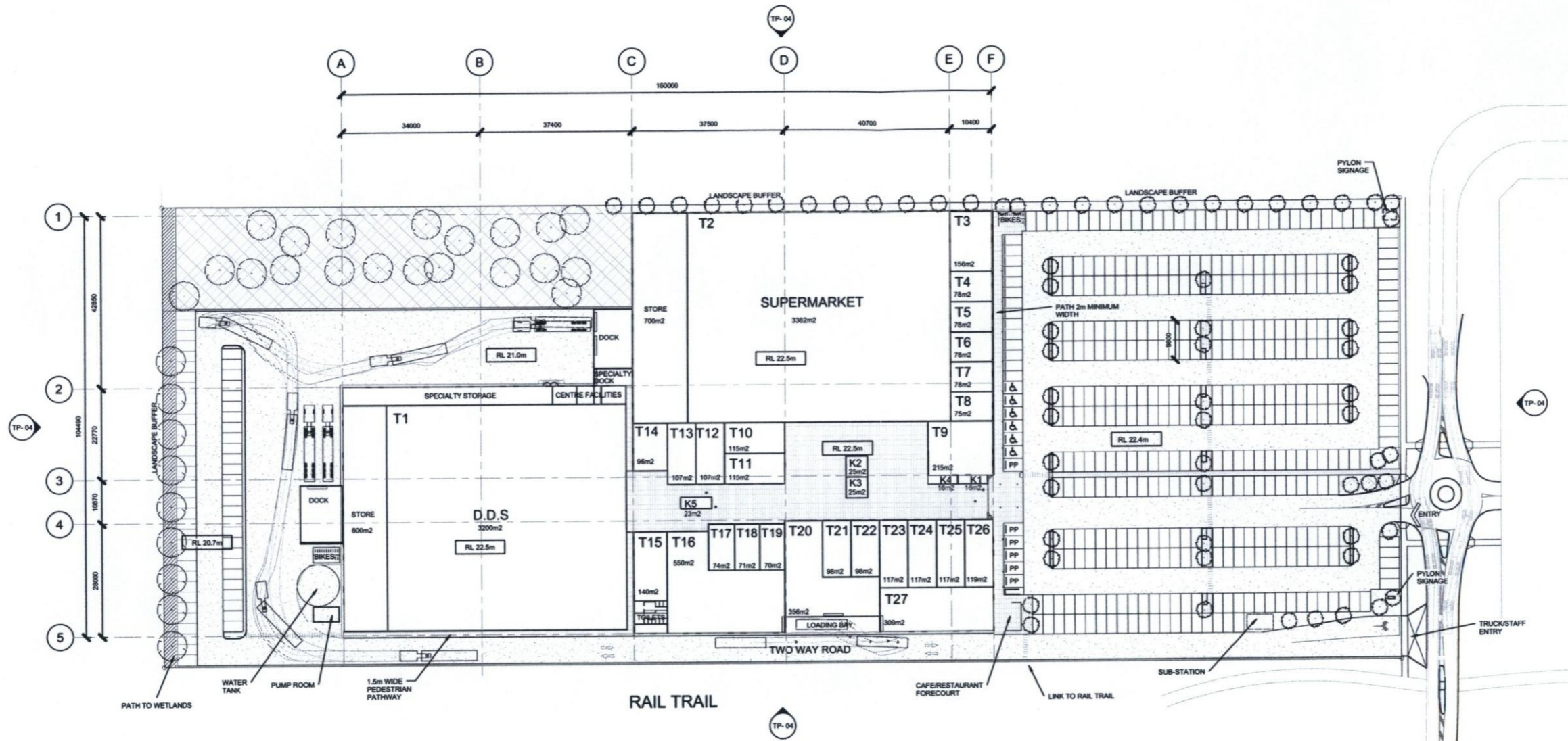

AREA SCHEDULE	
NAME	AREA
T01	3200
T02	3382m2
T03	156m2
T04	78m2
T05	78m2
T06	78m2
T07	78m2
T08	75m2
T09	215m2
T10	115m2
T11	115m2
T12	107m2
T13	107m2
T14	96m2
T15	140m2
T16	550m2
T17	74m2
T18	71m2
T19	70m2
T20	356m2
T21	98m2
T22	98m2
T23	117m2
T24	117m2
T25	117m2
T26	119m2
T27	309m2
K01	16m2
K02	25m2
K03	25m2
K04	16m2
K05	23m2

TOTAL CAR PARKS
469

ENDORSED DEVELOPMENT PLAN.
 Planning and Environment Act 1967.
 Bass Coast Planning Scheme Clause 43.04
 Schedule..... 9
 This Development Plan was approved by Council at the meeting of
 21 April 2010
 For and on behalf of the Responsible Authority
 Date 10 August 2010

SCALE IN METRES (1:100 ON B1 SHEET, 1:250 ON A3 SHEET)

TOWN PLANNING APPLICATION

RPC ARCHITECTS
 102 South Road, Hughesdale
 PO Box 5111, Hughesdale 3166
 P 03 9564 6000 F 03 9564 6099
 E office@rpcarchitects.com.au

ISSUE: DATE: AMENDMENT:
 CLIENT:
 PROJECT:
 DRAWING TITLE:

WON INVESTMENTS PTY LTD
 WONTHAGGI PLAZA SHOPPING CENTRE
 DEVELOPMENT PLAN

DRAWING NO.:
 ISSUE: 0
 DATE: JULY 2010 JOB NO.:
 REF: TOWN PLANNING 1745
 DRAWN BY: LCM

