

BASS HIGHWAY (WHITE ROAD)

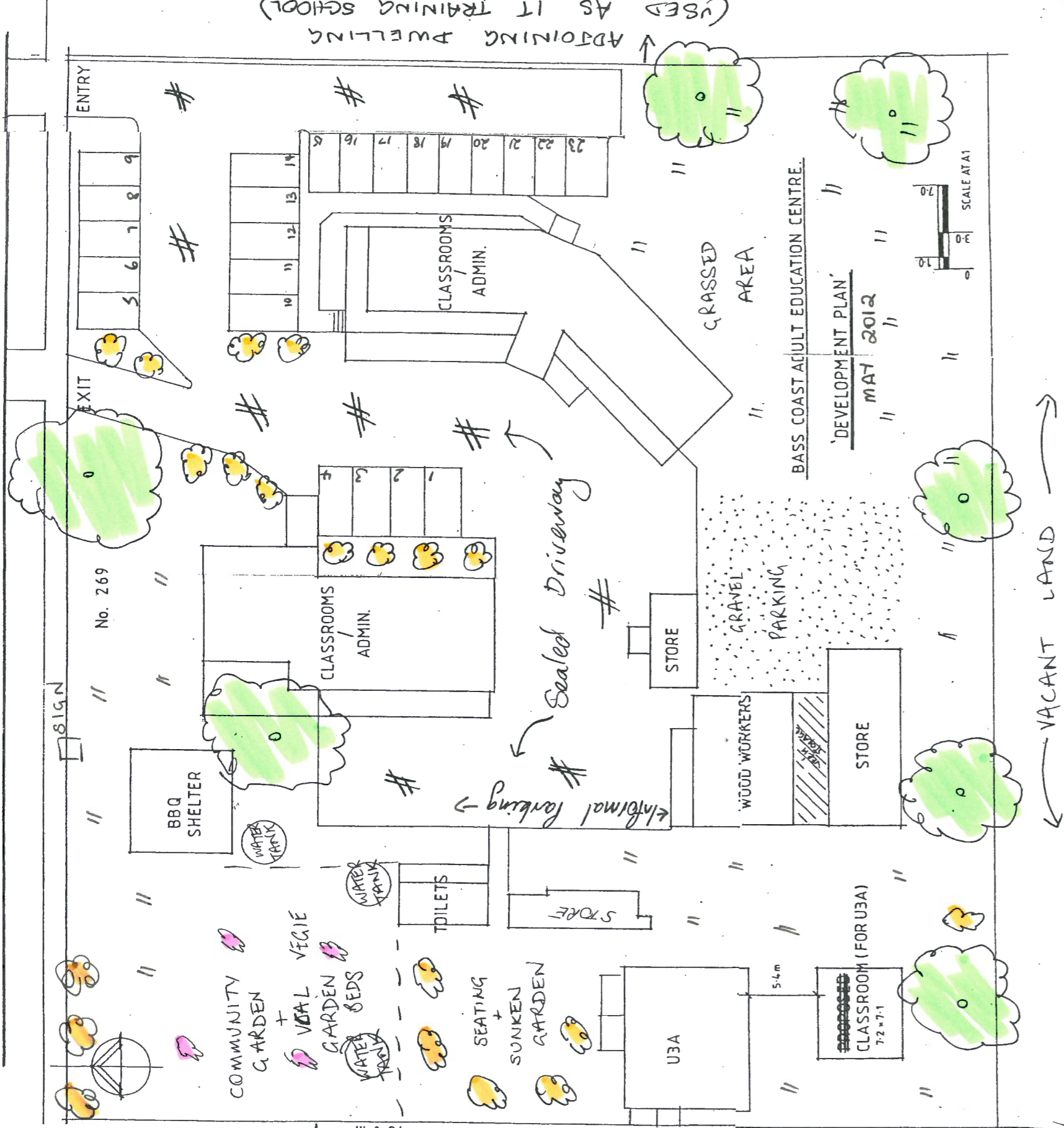

(USED AS IT TRAINING BUILDING)  
ADJOINING BUILDING

CHISHOLM TAFE BUILDINGS  
70.0 metres

VACANT LAND

WONTHAGGI SECONDARY COLLEGE  
84.0 metres

MAJOR TREES	
SHRUBS	
VEAL + COMMUNITY VEGIE GARDEN BEDS	
LAWN AREA	" "
SEALED DRIVEWAY (ASPHALT)	# #
GRAVEL SURFACE	

LEGEND

**ENDORSED DEVELOPMENT PLAN.**  
Planning and Environment Act 1987.  
Bass Coast Planning Scheme Clause 43.04  
Schedule.....**DPO 10**  
This Development Plan was approved by Council at the meeting of  
**12 February 2004**  
For and on behalf of the Responsible Authority  
Date.....**21.05.2012**