

AA Landscape Plan - Callout AA  
PL-04

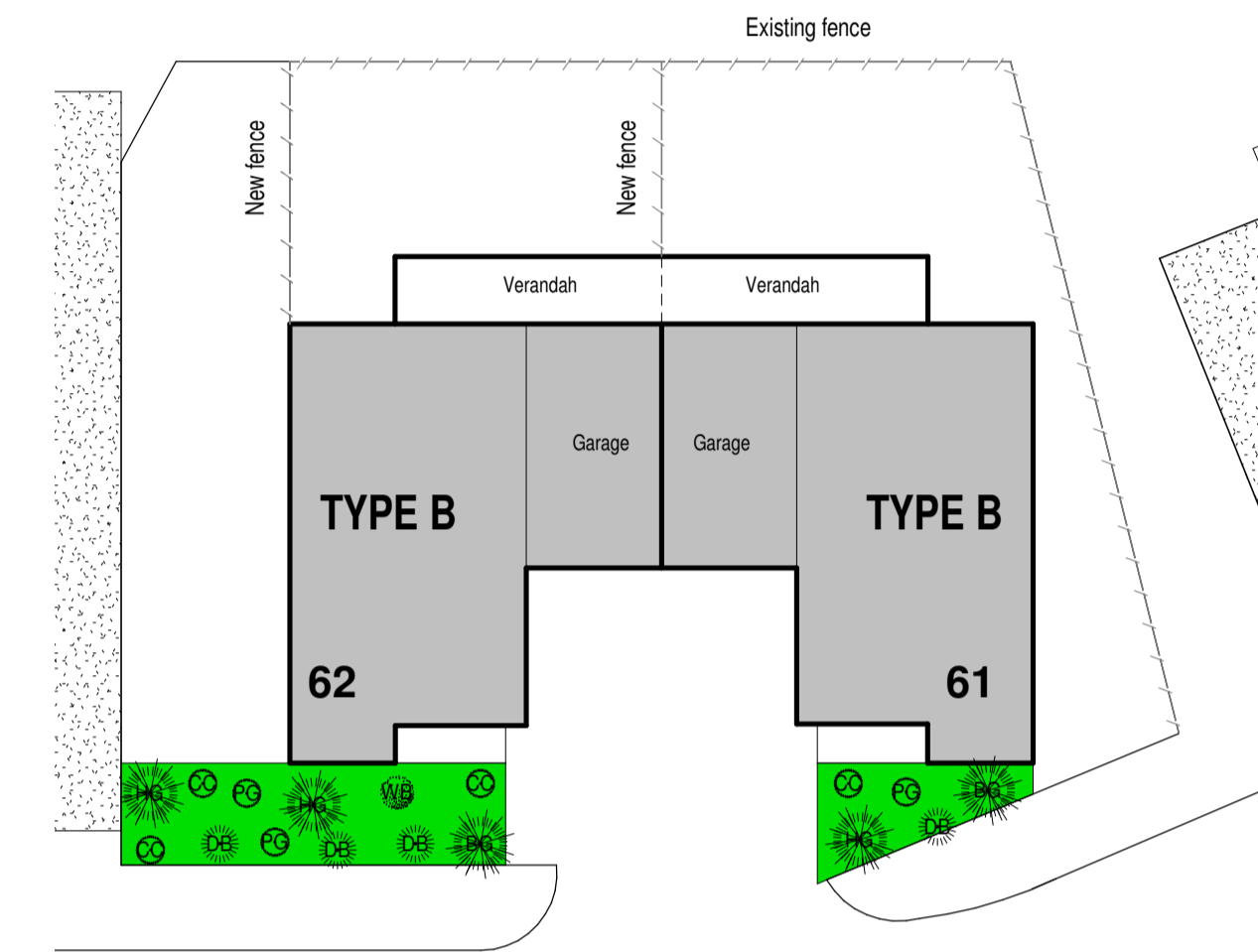

BB Landscape Plan - Callout BB  
PL-04 1:200

**GENERAL LANDSCAPING NOTES:-**

- Contractor to verify location of all underground services prior to commencement of work.
- Remove weeds from all areas shown on the drawings as garden bed and lawn. Herbicide to be used sparingly.
- Determine pH of soil using pH kit available at most nurseries. The soil should have a pH slightly acidic to neutral (pH - 5.5 to 7.0). If outside of this range contact your local nursery to obtain advice on improving the pH level. Plant tolerance of high or low pH varies.
- Plant selection shall be as per the plant schedule in locations as shown on the drawings. Plants are to have well developed root systems and be free of pest and disease. Water plants according to individual species' moisture needs and seasonal conditions.
- Add gypsum to clay soil at 1.5kg/m<sup>2</sup> of garden bed area. Gypsum assists in breaking up clay and allows plant roots to penetrate the soil.
- Install subsurface drainage to discharge stormwater or soakage pits in areas of poor drainage unless moisture-loving plants are specified.
- Cultivate soil to a depth of 300mm for garden beds and 100mm for lawns.
- Re-use topsoil from site where possible and apply at a depth of 150mm for lawns and 200mm for garden beds. Ensure both re-used and imported topsoil is fertile, contains organic matter and is free from weeds, roots, stones or rubble.
- Apply organic mulch to all garden bed areas to a depth of 75mm as per planting details.
- Seasol is an ideal fertiliser to apply upon initial planting. Seasol targets roots and promotes healthy and balanced growth. Phostogen is an ideal liquid fertiliser that can be applied to the entire garden every three months. Individual plant species have varying requirements. Consult your local nursery for advice.
- Stake trees for one to two years. Use two or three 38x38x1800 HW stakes per tree and fasten with 50mm fabric ties. All climbers require wire or trellis climbing frame to be attached to the adjacent surface.
- Use timber edging all garden bed and lawn areas.
- Areas shown as lawn on the drawings are to be re-graded to provide smooth contours and raked to remove soil clods and rubble.
- Water lawn areas during establishment in accordance with State guidelines as advised by Local Water authority.
- Landscaping must be maintained and any dead, diseased or damaged plants are to be replaced.

**Planting Schedule**

Type Mark	Common Name	Botanical Name	Type & Mature Height	Qty
BG	Bundled Guinea-Flower	Hibbertia Prostrata	Low Shrubs (<2M)	4
CC	Common Correa	Correa Reflexa	Low Shrubs (<2M)	8
CH	Common Heath	Epacris Impressa	Low Shrubs (<2M)	1
DB	Dusty Daisy Bush	Olearia Phlogopappa	Low Shrubs (<2M)	16
HG	Hop Goodenia	Goodenia Avata	Low Shrubs (<2M)	7
PG	Prickly Geebung	Persoonia Juniperina	Low Shrubs (<2M)	13
WB	Wiry Bauera	Bauera Rubioides	Low Shrubs (<2M)	3
WC	White Correa	Correa Alba	Low Shrubs (<2M)	1

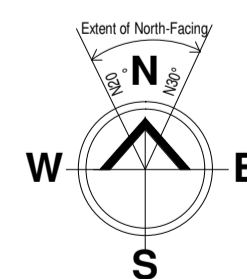

AA Landscape Key Plan  
PL-04 1:1000

Bushfire Attack Classification:-	N/A	Cape Paterson Road Wonthaggi 3995 Ph: 03 56 721 999 Fax: 03 56 722 979	
Wind Classification:-	N2	Soil Classification:-	M
Owner Signature:-	COLDON HOMES		
Drawing Title:-	Project: 32-42 Ullathornes Road INVERLOCH (SUNNY SAND RESIDENTIAL VILLAGE)		
Issued For:-	Client: Inverloch Village Pty Ltd		
Scale:	As indicated @ A1	Date:	Sept 20
Drawn:	Wal	Chk:	Checker
Job No:	20-AAA	Sheet Name:	PL-04
REV	DATE	DESCRIPTION	DRW BY
			21-Dec-20 10:52 AM