

**REGISTER SEARCH STATEMENT (Title Search) Transfer of
Land Act 1958**

VOLUME 08835 FOLIO 968

Security no : 124086501373W
Produced 10/11/2020 05:02 PM

LAND DESCRIPTION

Lot 10 on Plan of Subdivision 072408.
PARENT TITLE Volume 07445 Folio 974
Created by instrument D754419 24/06/1970

REGISTERED PROPRIETOR

Estate Fee Simple
Joint Proprietors
ROGER JAMES KILPATRICK
DEBRA JOAN KILPATRICK both of 19 HILLSIDE AVENUE INVERLOCH VIC 3996
AH476285Q 06/09/2010

ENCUMBRANCES, CAVEATS AND NOTICES

MORTGAGE AH476286N 06/09/2010
NATIONAL AUSTRALIA BANK LTD

COVENANT D754419 24/06/1970

Any encumbrances created by Section 98 Transfer of Land Act 1958 or Section 24 Subdivision Act 1988 and any other encumbrances shown or entered on the plan or imaged folio set out under DIAGRAM LOCATION below.

DIAGRAM LOCATION

SEE LP072408 FOR FURTHER DETAILS AND BOUNDARIES

ACTIVITY IN THE LAST 125 DAYS

NIL

-----END OF REGISTER SEARCH STATEMENT-----

Additional information: (not part of the Register Search Statement)

Street Address: 19 HILLSIDE AVENUE INVERLOCH VIC 3996

ADMINISTRATIVE NOTICES

NIL

eCT Control 16089P NATIONAL AUSTRALIA BANK LIMITED
Effective from 23/10/2016

DOCUMENT END

LP72408
EDITION 3
APPROVED 31/3/166

PLAN OF SUBDIVISION

PART OF CROWN ALLOT. I SEC. I

PARISH OF KIRRAK

Measurements are in Feet & Inches
Conversion Factor
FEET X 0.3048 = METRES

Note: The land coloured blue is set aside for drainage and sewerage purposes.

COLOUR CONVERSION
E-1=BLUE
R1=BROWN

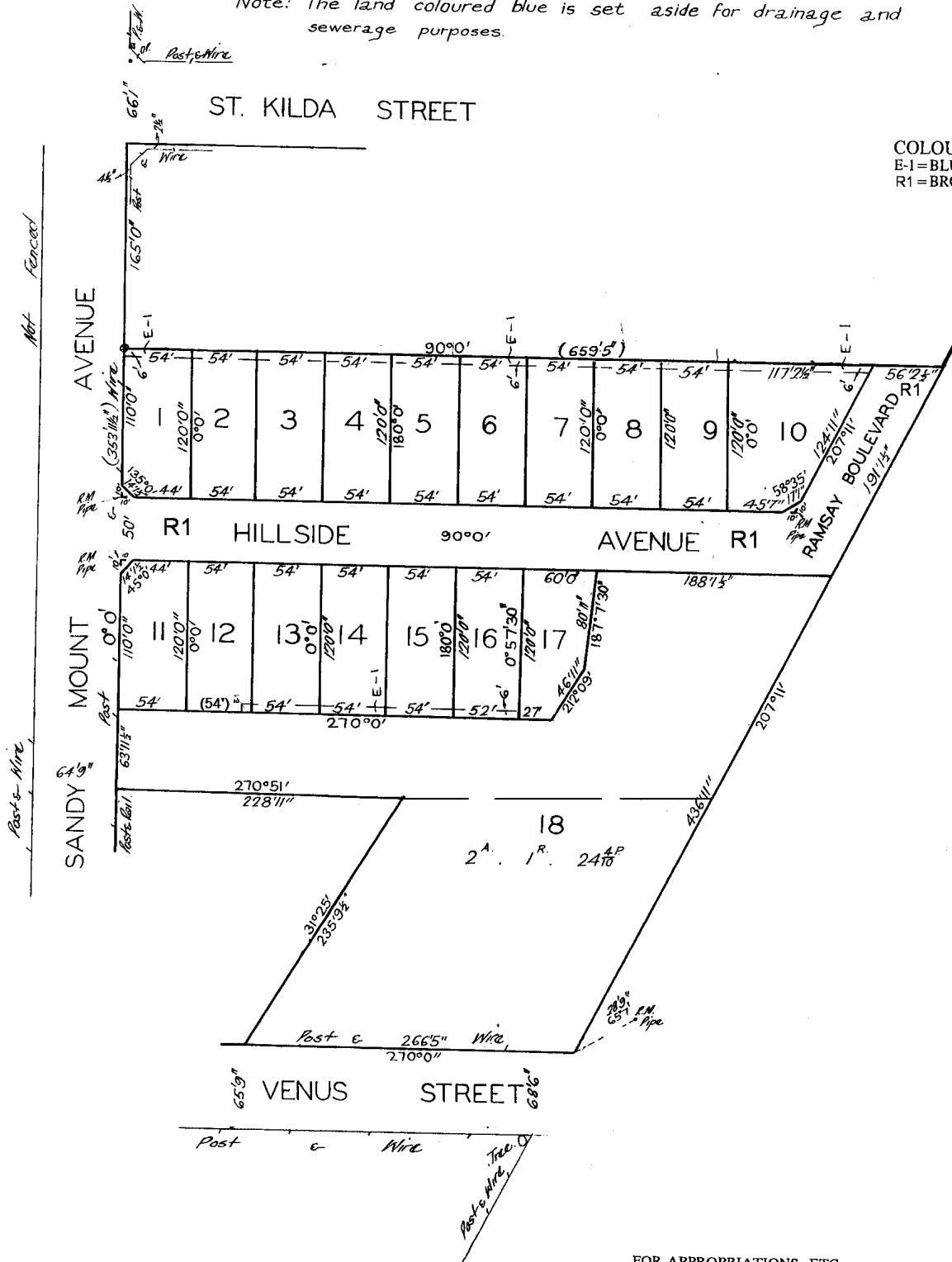

FOR APPROPRIATIONS, ETC,
SEE BACK HEREOF

CERTIFICATE OF TITLE V. 7445 F. 974
8403 951

LODGED BY PEARCE & WEBSTER

DATE 17. 2. 66

DECLARED BY R. A. BEVERIDGE 30. 4. 65

CONSENT OF COUNCIL SHIRE OF WOODRAY

14. 5. 65

PLAN APPROVED DATE 31. 3. 66 TIME 2. 14

LP 72408
BACK OF SHEET 1

THE LAND COLOURED BLUE
IS APPROPRIATED
OR SET APART FOR
EASEMENTS OF DRAINAGE AND SEWERAGE

THE LAND COLOURED BROWN
IS APPROPRIATED
OR SET APART FOR
EASEMENTS OF WAY

D754419

D754419

REGD

*** 11.00 A RT T

NEW TITLE
NO 106
BY LETTERS
JUN 24-70

JOHN A. LYONS, LL.B.
65 Kingsway, Glen Waverley.

A. B. Pearce, Webster

VICTORIA

DIRECTION TRANSFER

ds
\$88-75
9

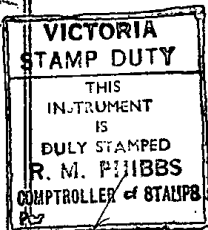

I, GEOFFREY PAUL MOLLER Motel Proprietor of 2 Sandy Mount Avenue Inverloch being registered as the proprietor of an estate in fee simple in the land hereinafter described subject to the encumbrances notified hereunder IN CONSIDERATION of the sum of TWO THOUSAND SIX HUNDRED DOLLARS (\$2,600.00c) paid to him by LEONARD ERNEST FIELD Engineer and EDITH JOYCE FIELD Married Woman both of 41 Fourth Street Parkdale and in FURTHER CONSIDERATION of the sum of FOUR THOUSAND FIVE HUNDRED DOLLARS (\$4,500.00c) paid to the said Leonard Ernest Field and Edith Joyce Field by RONALD STERLING MARSH Technical Officer and GWENDOLINE MARY MARSH Married Woman both of 21 Florence Street Glen Waverley DO HEREBY TRANSFER to the said ~~Ronald Sterling Marsh and Gwendoline Mary Marsh~~ by direction of Leonard Ernest Field and Edith Joyce Field (as testified by their execution hereof) all his estate and interest in ALL THAT piece of land being Lot 10 on Plan of Subdivision No. 72408 Parish of Kirrak and being part of the land more particularly described in Certificate of Title Volume 7445 Folio 974 AND the said Ronald Sterling Marsh and Gwendoline Mary Marsh DO TH HEREBY for themselves their executors administrators and transferees the registered proprietor or proprietors for the time being of the said land and every part thereof COVENANT with the said Geoffrey Paul Moller his executors administrators and transferees or other the registered proprietor or proprietors for the time being of the land comprised in the said Plan of Subdivision and every part thereof (other than the land hereby transferred) that they will not erect nor allow or permit to be erected on the said Lot hereby transferred any building other than one dwelling house with usual outbuildings and that the said dwelling house exclusive of outbuildings shall not be of less than Four thousand dollars in value and that the said dwelling house shall have a floor area of not less than 800

FEE RED + BLUE
C/T 7445-974
ENC: BLUE - X98
AS PERH - COVT. MEMO

SR AND
8/11/70
10/7/70

JUN-16-70 2000101 38258

LEA1015***88-75



square feet and that the said dwelling house shall be constructed entirely of new materials of the best quality and that the said dwelling house shall be of one storey only with one floor level only the floor bearers of which at one point shall not be more than two feet higher than the present ground level and that no earth clay gravel or sand shall be removed from the said land except for the purpose of preparing for the foundations of any building to be erected thereon AND it is intended that the foregoing covenant shall appear as an encumbrance on the Certificate of Title to issue in respect of the Transfer of the land hereby sold and shall run with the said land.

DATED this *22nd* day of *May* One thousand nine hundred and seventy.

SIGNED by the said GEOFFREY PAUL MOLLER in Victoria in the presence of:

[Signature]

SIGNED by the said LEONARD ERNEST FIELD in Victoria in the presence of:

L. E. Field

SIGNED by the said EDITH JOYCE FIELD in Victoria in the presence of:

E. J. Field

SIGNED by the said RONALD STERLING MARSH in Victoria in the presence of:

R. S. Marsh

SIGNED by the said GWENDOLINE MARY MARSH in Victoria in the presence of:

G. M. Marsh

M. Simpson

ENCUMBRANCES REFERRED TO:

The encumbrances as set out at the foot of the said Certificate of Title.

To the Registrar of Titles
I have prepared this transfer and
upon effect of completion of title to Landy's property
I send title to section four.
D. Macdonald

G.P. MOLLER

to

L.E. & E.J. FIELD

to

R.S. & G.M. MARSH

DIRECTION TRANSFER

JOHN A. LYONS, LL.B.,
Solicitor,
65 Kingsway,
GLEN WAVERLEY.

A memorandum of the within instrument
has been entered in the Register Book

See Vol. 7445 Fol. 974

